

RONIS 8800 Nut Fix Master Keyed Mini Camlock

Nut Fix · Ronis · 1 variant

PRICING

From £15.93 ex VAT

£19.12 inc VAT

1 variant available
VAT 20.00%

Product Imagery

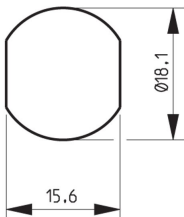
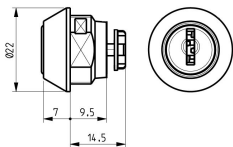

Specification Summary

Brand Ronis

Product type Nut Fix

Product Description

The RONIS 8800 Nut Fix Master Keyed Mini Camlock is a compact and highly reliable locking solution designed for applications such as metal furniture, lockers, and cabinets. Utilising a robust wafer mechanism, this camlock offers a secure yet cost-effective security solution. It is supplied under the SM Master Key series, allowing for seamless integration into new or existing master key systems.

Featuring a compact 8.5mm body length, this mini camlock is ideal for installations where space is limited. It is secured in place using a convenient nut fixing method, ensuring a stable and durable fit. The lock operates with a 180° clockwise and anti-clockwise movement, providing flexible operation, and is finished in a clean bright nickel.

This model is compatible with the Ronis 4929 cam series and comes complete with two keys.

Technical Specifications

- **Manufacturer Reference:** 8800-D01-L2-C1-SM
- **Body Length:** 8.5mm
- **Body Diameter:** 18.1mm
- **Body Width:** 15.6mm
- **Body Height:** 18.1mm
- **Head Diameter:** 22mm
- **Head Shape:** Round
- **Cam Height:** 40mm
- **Key Series:** SM Series
- **Keying:** Master Keyed (Stocked)
- **Keys Supplied:** 2
- **Mechanism:** Wafer
- **Movement:** 180° Clockwise & Anti-Clockwise
- **Fixing:** Nut Fix
- **Finish:** Bright Nickel
- **Compatible Cam Series:** Ronis 4929 Cam Series
- **Weight:** 50g

Key Features

- **Master Key Compatible:** Supplied under the SM Master Key series, making it easy to integrate into master key suites.
- **Compact Design:** Features an 8.5mm body length, perfect for small enclosures, lockers, and metal furniture.
- **Secure Nut Fixing:** Threaded body with nut fixing ensures a secure and stable installation.
- **Flexible Operation:** Offers a full 180° clockwise and anti-clockwise movement.
- **Reliable Wafer Mechanism:** Provides dependable, everyday security with up to 200 key combinations (differs).
- **Complete Package:** Supplied with two keys as standard.

Variant Specifications And Pricing

Image	Part Number	Ex VAT	Inc VAT	Attributes / Specs
	L26808	£15.93	£19.12	<p>Barcode: 5055120781082</p> <p>Body Diameter: 18.1mm</p> <p>Body Height: 18.1mm</p> <p>Body Length: 8.5mm</p> <p>Body Width: 15.6mm</p> <p>Brand: Ronis</p> <p>Cam Height: 40mm</p> <p>Differs: 200</p> <p>Finish: Bright Nickel</p> <p>Fixing: Nut</p> <p>Head Diameter: 22mm</p> <p>Head Shape: Round</p> <p>Key Series: SM</p> <p>Keyed: Master Keyed</p> <p>Keying - MK: Stocked</p> <p>Keys Supplied: 2</p> <p>Manufacturer Reference: 8800-D01-L2-C1-SM</p> <p>Mechanism: Wafer</p> <p>Movement: 180° Clockwise & Anti Clockwise</p> <p>Notes: Master Keyed - SM With Lock Fixing ID - L1, Hole Profile - 10100, Direction ID - D02 & Cam Fixing ID - C1.</p> <p>Pack Quantity: 1</p> <p>Suits Product: Ronis 4929 Cam Series</p> <p>Weight: 50g</p>

Brand Profile

Ronis



RONIS is an industrial locking brand best known for the unglamorous-but-essential stuff that keeps the modern world closed: **cam locks, quarter-turn locks, enclosure locks, locker/furniture locks**, and other OEM-friendly locking components used in **electrical cabinets, switchgear, lockers, vending/utility enclosures, postal equipment, and industrial furniture**. It's the kind of brand you don't notice until a whole site can't open a cabinet, and then suddenly it's the main character.

Today, **RONIS is a brand within the DOM Security group** (often referenced as **DOM RONIS**), and it's positioned as one of the major players in **industrial locks and mechanical components** for manufacturers.

What RONIS is really about is **OEM / turnkey supply**: providing manufacturers with ready-to-integrate locking solutions rather than one-off "retail" locks. DOM's own positioning for DOM RONIS is explicitly **designing, manufacturing and marketing OEM security systems for industry** and delivering **turnkey solutions**.

On the product side, the brand is heavily associated with **robust cam lock families**—e.g., models like the **RONIS 8800 / 32150 / 1710** ranges are described as cast, one-piece bodies aimed at durability and proven performance (the "this cabinet will be opened 12,000 times and nobody will lubricate it" design philosophy).