

RONIS 26210 Nut Fix Master Keyed Camlock

Nut Fix · Ronis · 1 variant

PRICING

From £32.70 ex VAT

£39.24 inc VAT

1 variant available
VAT 20.00%

Product Imagery

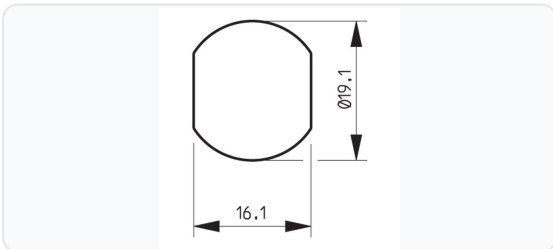
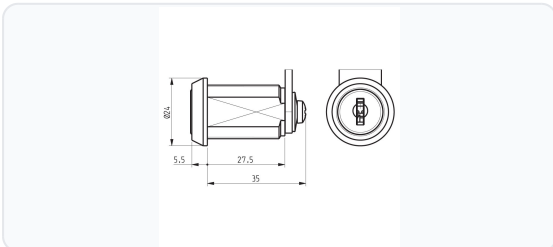

Specification Summary

Brand Ronis

Product type Nut Fix

Product Description

The RONIS 26210 Nut Fix Master Keyed Camlock is a robust and reliable locking solution designed for a wide range of applications, including metal and wood furniture, lockers, electrical cabinets, and retail storage. Utilising high-quality wafer technology, this camlock provides dependable security and is supplied master keyed under the popular KT key series, making it easy to integrate into new or existing master key systems.

Constructed with a single-piece cast body for long-lasting durability, the lock features a round face and is finished in bright nickel. It is secured firmly in place using a nut fixing, operates with a smooth 90-degree clockwise movement, and comes supplied with two keys as standard. With a body length of 27.6mm and a head diameter of 24mm, this compact camlock offers up to 2,000 key combinations (differs) for enhanced security.

Technical Specifications

- **Brand:** Ronis
- **Manufacturer Reference:** 26210-D02-L2-C3-KT
- **Body Length:** 27.6mm
- **Body Diameter:** 19.1mm
- **Body Width:** 16.1mm
- **Body Height:** 19.1mm
- **Head Diameter:** 24mm
- **Head Shape:** Round
- **Cam Height:** 31mm
- **Finish:** Bright Nickel
- **Fixing Type:** Nut Fix
- **Mechanism:** Wafer
- **Key Series:** KT Series
- **Keying:** Master Keyed (Stocked)
- **Key Combinations (Differs):** 2,000
- **Movement:** 90° Clockwise
- **Keys Supplied:** 2
- **Weight:** 70g

Key Features

- **Master Keyed Compatibility:** Supplied under the KT key series, allowing seamless integration into master key systems.
- **Robust Construction:** Single-piece cast body made from high-quality materials for a long service life.
- **Secure Nut Fixing:** Designed for efficient and secure installation using a standard nut fixing.
- **Smooth Operation:** Features a 90° clockwise rotation for reliable locking and unlocking.
- **Generous Key Differs:** Offers up to 2,000 key combinations for enhanced security.
- **Complete Package:** Supplied with 2 keys as standard.

Variant Specifications And Pricing

Image	Part Number	Ex VAT	Inc VAT	Attributes / Specs
	L26811	£32.70	£39.24	<p> Barcode: 5055120781112 Body Diameter: 19.1mm Body Height: 19.1mm Body Length: 27.6mm Body Width: 16.1mm Brand: Ronis Cam Height: 31mm Differs: 2,000 Finish: Bright Nickel Fixing: Nut Head Diameter: 24mm Head Shape: Round Key Series: KT Keyed: Master Keyed Keying - MK: Stocked Keys Supplied: 2 Manufacturer Reference: 26210-D02-L2-C3-KT Mechanism: Wafer Movement: 90° Clockwise Notes: Master Keyed - KT With Lock Fixing ID - L2, Hole Profile - 10500, Direction ID - D02 & Cam Fixing ID - C3. Pack Quantity: 1 Weight: 70g </p>

Brand Profile

Ronis



RONIS is an industrial locking brand best known for the unglamorous-but-essential stuff that keeps the modern world closed: **cam locks, quarter-turn locks, enclosure locks, locker/furniture locks**, and other OEM-friendly locking components used in **electrical cabinets, switchgear, lockers, vending/utility enclosures, postal equipment, and industrial furniture**. It's the kind of brand you don't notice until a whole site can't open a cabinet, and then suddenly it's the main character.

Today, **RONIS is a brand within the DOM Security group** (often referenced as **DOM RONIS**), and it's positioned as one of the major players in **industrial locks and mechanical components** for manufacturers.

What RONIS is really about is **OEM / turnkey supply**: providing manufacturers with ready-to-integrate locking solutions rather than one-off "retail" locks. DOM's own positioning for DOM RONIS is explicitly **designing, manufacturing and marketing OEM security systems for industry** and delivering **turnkey solutions**.

On the product side, the brand is heavily associated with **robust cam lock families**—e.g., models like the **RONIS 8800 / 32150 / 1710** ranges are described as cast, one-piece bodies aimed at durability and proven performance (the "this cabinet will be opened 12,000 times and nobody will lubricate it" design philosophy).