

RONIS 26200 Nut Fix Master Keyed Camlock

Nut Fix · Ronis · 1 variant

PRICING

From £30.41 ex VAT

£36.49 inc VAT

1 variant available
VAT 20.00%

Product Imagery

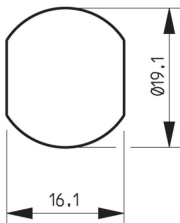
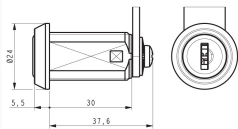

Specification Summary

Brand Ronis

Product type Nut Fix

Product Description

The RONIS 26200 Nut Fix Master Keyed Camlock is a high-quality, reliable locking solution designed primarily for metal cupboards, lockers, and office furniture. Featuring a 30mm body length and a bright chrome finish, this camlock combines durability with a clean, professional aesthetic.

Operating on the KT Master Key Series, this wafer-mechanism lock offers up to 2,000 key combinations (differs), providing a high level of key security for commercial and personal storage. The lock is designed with a round face and is secured in place using a robust nut fixing. It features a versatile 180° clockwise and anti-clockwise movement, ensuring smooth operation, and is supplied complete with two keys.

Whether you are replacing an existing lock or installing a new security system for office cabinets, the Ronis 26200 provides a dependable, master-keyed solution.

Technical Specifications

- **Brand:** Ronis
- **Body Length:** 30mm
- **Body Diameter:** 19.1mm
- **Body Height:** 19.1mm
- **Body Width:** 16.1mm
- **Head Diameter:** 24mm (Round)
- **Cam Height:** 31mm
- **Fixing Type:** Nut fixing
- **Key Series:** KT Series
- **Keying:** Master Keyed (Stocked)
- **Mechanism:** Wafer
- **Movement:** 180° Clockwise & Anti-Clockwise
- **Keys Supplied:** 2
- **Finish:** Bright Chrome
- **Weight:** 60g

Key Features

- **Master Key Compatible:** Supplied under the KT Master Key Series for convenient multi-lock management.
- **High Security Differs:** Offers up to 2,000 key combinations for enhanced security.
- **Durable Construction:** Features a robust wafer mechanism and a corrosion-resistant Bright Chrome finish.
- **Versatile Operation:** Provides 180° clockwise and anti-clockwise rotation to suit various cabinet configurations.
- **Easy Installation:** Securely mounts to metal cupboards and lockers using the included nut fixing.

Variant Specifications And Pricing

Image	Part Number	Ex VAT	Inc VAT	Attributes / Specs
	L26812	£30.41	£36.49	<p>Barcode: 5055120781129</p> <p>Body Diameter: 19.1mm</p> <p>Body Height: 19.1mm</p> <p>Body Length: 30mm</p> <p>Body Width: 16.1mm</p> <p>Brand: Ronis</p> <p>Cam Height: 31mm</p> <p>Differs: 2,000</p> <p>Finish: Bright Chrome</p> <p>Fixing: Nut</p> <p>Head Diameter: 24mm</p> <p>Head Shape: Round</p> <p>Key Series: KT</p> <p>Keyed: Master Keyed</p> <p>Keying - MK: Stocked</p> <p>Keys Supplied: 2</p> <p>Manufacturer Reference: 26200-D01-L2-C3-KT</p> <p>Mechanism: Wafer</p> <p>Movement: 180° Clockwise & Anti Clockwise</p> <p>Notes: Master Keyed - KT With Lock Fixing ID - L2, Hole Profile - 10500, Direction ID - D02 & Cam Fixing ID - C3.</p> <p>Pack Quantity: 1</p> <p>Weight: 60g</p>

Brand Profile

Ronis



RONIS is an industrial locking brand best known for the unglamorous-but-essential stuff that keeps the modern world closed: **cam locks, quarter-turn locks, enclosure locks, locker/furniture locks**, and other OEM-friendly locking components used in **electrical cabinets, switchgear, lockers, vending/utility enclosures, postal equipment, and industrial furniture**. It's the kind of brand you don't notice until a whole site can't open a cabinet, and then suddenly it's the main character.

Today, **RONIS is a brand within the DOM Security group** (often referenced as **DOM RONIS**), and it's positioned as one of the major players in **industrial locks and mechanical components** for manufacturers.

What RONIS is really about is **OEM / turnkey supply**: providing manufacturers with ready-to-integrate locking solutions rather than one-off "retail" locks. DOM's own positioning for DOM RONIS is explicitly **designing, manufacturing and marketing OEM security systems for industry** and delivering **turnkey solutions**.

On the product side, the brand is heavily associated with **robust cam lock families**—e.g., models like the **RONIS 8800 / 32150 / 1710** ranges are described as cast, one-piece bodies aimed at durability and proven performance (the "this cabinet will be opened 12,000 times and nobody will lubricate it" design philosophy).