

RONIS 25300 Nut Fix Master Keyed Camlock

Nut Fix · Ronis · 1 variant

PRICING

From £23.78 ex VAT

£28.54 inc VAT

1 variant available
VAT 20.00%

Product Imagery

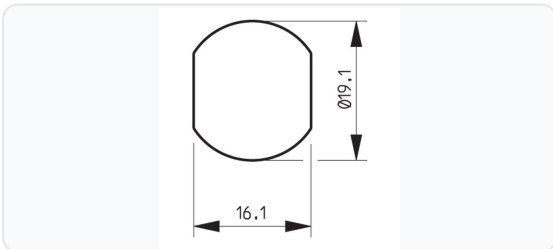
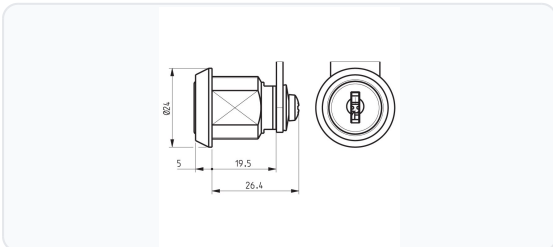

Specification Summary

Brand Ronis

Product type Nut Fix

Product Description

The RONIS 25300 Nut Fix Master Keyed Camlock is a reliable and robust locking solution designed for securing metal cupboards, lockers, cabinets, and office furniture. Featuring a durable wafer mechanism and a clean round face, this camlock is finished in bright chrome to provide a professional look alongside excellent corrosion resistance.

Supplied under the CC Master Key Series, this lock is ideal for integration into new or existing master key systems where administrative or master key control is required. It offers up to 2,000 key combinations (differs) for enhanced security and comes complete with two keys as standard. Installation is straightforward and secure thanks to its nut fixing design, ensuring a tight, stable fit on compatible panels.

Technical Specifications

- **Brand:** Ronis
- **Manufacturer Reference:** 25300-D01-L2-C2-CC
- **Body Length:** 19.5mm
- **Body Diameter:** 19.1mm
- **Body Width:** 16.1mm
- **Head Diameter:** 24mm (Round Face)
- **Cam Height:** 31mm
- **Fixing Type:** Nut fixing
- **Mechanism:** Wafer
- **Key Series:** CC Series (Master Keyed)
- **Key Combinations:** 2,000 differs
- **Movement:** 180° clockwise and anti-clockwise
- **Keys Supplied:** 2
- **Finish:** Bright Chrome

Key Features

- **Master Key Compatible:** Supplied under the CC Master Key Series, making it perfect for commercial environments requiring master key access.
- **Robust Construction:** High-quality wafer mechanism housed in a durable body with a bright chrome finish.
- **Secure Nut Fixing:** Designed for a secure, stable installation on metal furniture, lockers, and cabinets.
- **Generous Key Differs:** Offers up to 2,000 unique key combinations to ensure high security across multiple installations.
- **Dual Keys Included:** Supplied with 2 keys as standard for immediate use.

Variant Specifications And Pricing

Image	Part Number	Ex VAT	Inc VAT	Attributes / Specs
	L26810	£23.78	£28.54	<p>Barcode: 5055120781105</p> <p>Body Diameter: 19.1mm</p> <p>Body Height: 19.1mm</p> <p>Body Length: 19.5mm</p> <p>Body Width: 16.1mm</p> <p>Brand: Ronis</p> <p>Cam Height: 31mm</p> <p>Differs: 2,000</p> <p>Finish: Bright Chrome</p> <p>Fixing: Nut</p> <p>Head Diameter: 24mm</p> <p>Head Shape: Round</p> <p>Key Series: CC</p> <p>Keyed: Master Keyed</p> <p>Keying - MK: Stocked</p> <p>Keys Supplied: 2</p> <p>Manufacturer Reference: 25300-D01-L2-C2-CC</p> <p>Mechanism: Wafer</p> <p>Movement: 180° Clockwise & Anti Clockwise</p> <p>Notes: Master Keyed - CC With Lock Fixing ID - L2, Hole Profile - 10500, Direction ID - D01 & Cam Fixing ID - C2.</p> <p>Pack Quantity: 1</p> <p>Weight: 70g</p>

Brand Profile

Ronis



RONIS is an industrial locking brand best known for the unglamorous-but-essential stuff that keeps the modern world closed: **cam locks, quarter-turn locks, enclosure locks, locker/furniture locks**, and other OEM-friendly locking components used in **electrical cabinets, switchgear, lockers, vending/utility enclosures, postal equipment, and industrial furniture**. It's the kind of brand you don't notice until a whole site can't open a cabinet, and then suddenly it's the main character.

Today, **RONIS is a brand within the DOM Security group** (often referenced as **DOM RONIS**), and it's positioned as one of the major players in **industrial locks and mechanical components** for manufacturers.

What RONIS is really about is **OEM / turnkey supply**: providing manufacturers with ready-to-integrate locking solutions rather than one-off "retail" locks. DOM's own positioning for DOM RONIS is explicitly **designing, manufacturing and marketing OEM security systems for industry** and delivering **turnkey solutions**.

On the product side, the brand is heavily associated with **robust cam lock families**—e.g., models like the **RONIS 8800 / 32150 / 1710** ranges are described as cast, one-piece bodies aimed at durability and proven performance (the "this cabinet will be opened 12,000 times and nobody will lubricate it" design philosophy).