

# RONIS 23750 32mm Nut Fix Latchlock To Suit 7.5mm Padlock

Nut Fix · Ronis · 1 variant

PRICING

**From £22.02 ex VAT**

£26.42 inc VAT

1 variant available  
VAT 20.00%

## Product Imagery

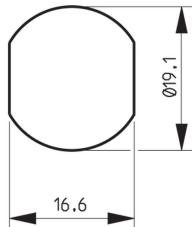
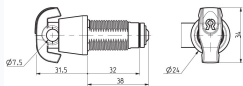

## Specification Summary

Brand Ronis

Product type Nut Fix

## Product Description

The RONIS 23750 32mm Padlockable Latchlock is a highly practical, keyless security solution designed for lockers, cupboards, and cabinets. By allowing users to secure the lock using their own padlock, it shifts the responsibility of security to the end-user and completely eliminates the administrative hassle of managing lost or broken keys for facility managers.

Constructed with a durable round face and finished in bright nickel, this latchlock features a 32mm body length and is secured firmly in place using a robust nut fixing. It operates with a smooth 90-degree clockwise movement and is designed to accommodate padlock shackles up to 7.5mm in diameter. It is an ideal choice for schools, gyms, workplaces, and public leisure facilities.

## Technical Specifications

- **Brand:** Ronis
- **Manufacturer Reference:** 23750-DS4-L2-C3
- **Body Length:** 32mm
- **Body Width:** 16mm
- **Cam Height:** 30mm
- **Finish:** Bright Nickel
- **Fixing:** Nut Fix
- **Head Shape:** Round
- **Movement:** 90° Clockwise
- **Maximum Shackle Diameter:** 7.5mm

## Key Features

- **Keyless Convenience:** Padlockable design eliminates the need for facility managers to distribute or replace keys.
- **Robust Compatibility:** Accommodates padlock shackles up to 7.5mm in diameter.
- **Durable Construction:** Finished in bright nickel for enhanced durability and a clean aesthetic.
- **Secure Installation:** Nut fixing ensures a tight, reliable fit on lockers and cabinet doors.
- **Smooth Operation:** Features a 90-degree clockwise rotation to lock and unlock.

### Variant Specifications And Pricing

Image	Part Number	Ex VAT	Inc VAT	Attributes / Specs
	L26822	£22.02	£26.42	<p><b>Barcode:</b> 5055120781228</p> <p><b>Body Length:</b> 32mm</p> <p><b>Body Width:</b> 16mm</p> <p><b>Brand:</b> Ronis</p> <p><b>Cam Height:</b> 30mm</p> <p><b>Finish:</b> Bright Nickel</p> <p><b>Fixing:</b> Nut</p> <p><b>Head Shape:</b> Round</p> <p><b>Manufacturer Reference:</b> 23750-DS4-L2-C3</p> <p><b>Movement:</b> 90° Clockwise</p> <p><b>Notes:</b> Cam Fixing ID - C3, Direction ID - DS4, Hole Profile - 10800 &amp; Lock Fixing ID - L2</p> <p><b>Pack Quantity:</b> 1</p> <p><b>Shackle Diameter:</b> 7.5mm</p> <p><b>Weight:</b> 102g</p>

## Brand Profile

Ronis



**RONIS** is an industrial locking brand best known for the unglamorous-but-essential stuff that keeps the modern world closed: **cam locks, quarter-turn locks, enclosure locks, locker/furniture locks**, and other OEM-friendly locking components used in **electrical cabinets, switchgear, lockers, vending/utility enclosures, postal equipment, and industrial furniture**. It's the kind of brand you don't notice until a whole site can't open a cabinet, and then suddenly it's the main character.

Today, **RONIS is a brand within the DOM Security group** (often referenced as **DOM RONIS**), and it's positioned as one of the major players in **industrial locks and mechanical components** for manufacturers.

What RONIS is really about is **OEM / turnkey supply**: providing manufacturers with ready-to-integrate locking solutions rather than one-off "retail" locks. DOM's own positioning for DOM RONIS is explicitly **designing, manufacturing and marketing OEM security systems for industry** and delivering **turnkey solutions**.

On the product side, the brand is heavily associated with **robust cam lock families**—e.g., models like the **RONIS 8800 / 32150 / 1710** ranges are described as cast, one-piece bodies aimed at durability and proven performance (the "this cabinet will be opened 12,000 times and nobody will lubricate it" design philosophy).