

# RONIS 23710 19.5mm Nut Fix Latchlock To Suit 7.5mm Padlock

Nut Fix · Ronis · 1 variant

**PRICING**

**From £20.33 ex VAT**

£24.40 inc VAT

1 variant available  
VAT 20.00%

**Product Imagery**

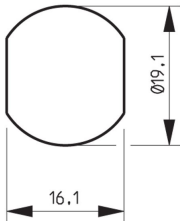
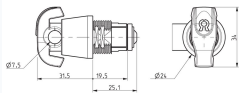

**Specification Summary**

Brand Ronis

Product type Nut Fix

**Product Description**

The RONIS 23710 Padlockable Latchlock is a practical, keyless locking solution designed specifically for steel lockers, cabinets, and personal storage units. By allowing users to secure the locker with their own padlock, it eliminates the administrative hassle of managing keys or combinations, making it an ideal choice for gyms, schools, workplaces, and public changing facilities.

Manufactured with a high-quality bright nickel finish, this 19.5mm body length camlock features a secure nut fixing for straightforward installation. It is designed to accept padlock shackles up to 7.5mm in diameter and operates with a smooth 90° clockwise movement.

Please note that padlocks are not included and must be purchased separately.

## Technical Specifications

- **Brand:** Ronis
- **Manufacturer Reference:** 23710-DS4-L2-C3
- **Body Length:** 19.5mm
- **Body Diameter:** 19.1mm
- **Body Width:** 16.1mm
- **Head Diameter:** 34mm
- **Cam Height:** 30mm
- **Fixing:** Nut fix
- **Movement:** 90° clockwise
- **Finish:** Bright Nickel
- **Maximum Shackle Diameter:** 7.5mm
- **Weight:** 70g

## Key Features

- **Keyless Security:** Puts the responsibility of securing the locker on the end user, removing the need for key management.
- **Padlock Compatible:** Accepts padlock shackles up to 7.5mm in diameter.
- **Durable Finish:** Supplied in a high-quality bright nickel finish.
- **Straightforward Installation:** Secure nut fixing ideal for steel lockers and cabinets.
- **Smooth Operation:** Features a 90° clockwise locking movement.

### Variant Specifications And Pricing

Image	Part Number	Ex VAT	Inc VAT	Attributes / Specs
	L26820	£20.33	£24.40	<p><b>Barcode:</b> 5055120781204</p> <p><b>Body Diameter:</b> 19.1mm</p> <p><b>Body Height:</b> 19.1mm</p> <p><b>Body Length:</b> 19.5mm</p> <p><b>Body Width:</b> 16.1mm</p> <p><b>Brand:</b> Ronis</p> <p><b>Cam Height:</b> 30mm</p> <p><b>Finish:</b> Bright Nickel</p> <p><b>Fixing:</b> Nut</p> <p><b>Head Diameter:</b> 34mm</p> <p><b>Manufacturer Reference:</b> 23710-DS4-L2-C3</p> <p><b>Movement:</b> 90° Clockwise</p> <p><b>Notes:</b> Lock Fixing ID - L2, Hole Profile - 10500, Direction ID - DS4 &amp; Cam Fixing ID - C3.</p> <p><b>Pack Quantity:</b> 1</p> <p><b>Shackle Diameter:</b> 7.5mm</p> <p><b>Weight:</b> 70g</p>

## Brand Profile

Ronis



**RONIS** is an industrial locking brand best known for the unglamorous-but-essential stuff that keeps the modern world closed: **cam locks, quarter-turn locks, enclosure locks, locker/furniture locks**, and other OEM-friendly locking components used in **electrical cabinets, switchgear, lockers, vending/utility enclosures, postal equipment, and industrial furniture**. It's the kind of brand you don't notice until a whole site can't open a cabinet, and then suddenly it's the main character.

Today, **RONIS is a brand within the DOM Security group** (often referenced as **DOM RONIS**), and it's positioned as one of the major players in **industrial locks and mechanical components** for manufacturers.

What RONIS is really about is **OEM / turnkey supply**: providing manufacturers with ready-to-integrate locking solutions rather than one-off "retail" locks. DOM's own positioning for DOM RONIS is explicitly **designing, manufacturing and marketing OEM security systems for industry** and delivering **turnkey solutions**.

On the product side, the brand is heavily associated with **robust cam lock families**—e.g., models like the **RONIS 8800 / 32150 / 1710** ranges are described as cast, one-piece bodies aimed at durability and proven performance (the "this cabinet will be opened 12,000 times and nobody will lubricate it" design philosophy).