

# RONIS 22510 19.5mm Nut Fix Latchlock To Suit 7.6mm Padlock

Nut Fix · Ronis · 1 variant

PRICING

**From £13.79 ex VAT**

£16.55 inc VAT

1 variant available  
VAT 20.00%

## Product Imagery

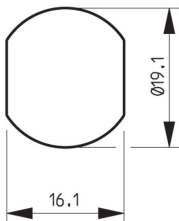
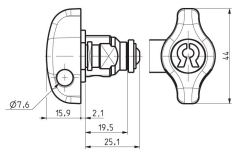

## Specification Summary

Brand Ronis

Product type Nut Fix

## Product Description

The RONIS 22510 19.5mm Nut Fix Latchlock is a highly practical, keyless locking solution designed for lockers, cabinets, and cupboards. By allowing users to secure the latchlock using their own padlock, it eliminates the administrative hassle of managing lost or broken keys - making it an ideal choice for gyms, schools, offices, and shared workspaces.

Crafted with a durable nickel-plated finish and a classic round face, this latchlock is built to withstand regular use while maintaining a clean, professional appearance. It features a secure nut fixing for straightforward installation and operates with a smooth 90° clockwise movement. The latchlock is designed to accept padlock shackles up to 7.6mm in diameter, offering versatile security options.

## Technical Specifications

- **Brand:** Ronis
- **Manufacturer Reference:** 22510-DS4-L2-C3
- **Body Length:** 19.5mm
- **Body Diameter:** 19.1mm
- **Body Width:** 16.1mm
- **Body Height:** 19.1mm
- **Cam Height:** 30mm
- **Head Diameter:** 44mm
- **Maximum Shackle Diameter:** 7.6mm
- **Movement:** 90° clockwise
- **Fixing Type:** Nut fixing
- **Finish:** Nickel Plated
- **Hole Profile:** 10500

## Key Features

- **Keyless Convenience:** Padlockable design allows users to secure lockers with their own padlock, reducing key management for facility managers.
- **Robust Construction:** High-quality nickel-plated finish provides excellent durability and a clean aesthetic.
- **Secure Installation:** Supplied with a reliable nut fixing to ensure a stable and secure fit.
- **Versatile Compatibility:** Accepts padlock shackles up to 7.6mm in diameter.
- **Smooth Operation:** Features a standard 90° clockwise rotation for easy locking and unlocking.

### Variant Specifications And Pricing

Image	Part Number	Ex VAT	Inc VAT	Attributes / Specs
	L26818	£13.79	£16.55	<p> <b>Barcode:</b> 5055120781181  <b>Body Diameter:</b> 19.1mm  <b>Body Height:</b> 19.1mm  <b>Body Length:</b> 19.5mm  <b>Body Width:</b> 16.1mm  <b>Brand:</b> Ronis  <b>Cam Height:</b> 30mm  <b>Finish:</b> Nickel Plated  <b>Fixing:</b> Nut  <b>Head Diameter:</b> 44mm  <b>Manufacturer Reference:</b> 22510-DS4-L2-C3  <b>Movement:</b> 90° Clockwise  <b>Notes:</b> Lock Fixing ID - L2, Hole Profile - 10500, Direction ID - DS4 &amp; Cam Fixing ID - C3.  <b>Pack Quantity:</b> 1  <b>Shackle Diameter:</b> 7.6mm  <b>Weight:</b> 70g         </p>

## Brand Profile

Ronis



**RONIS** is an industrial locking brand best known for the unglamorous-but-essential stuff that keeps the modern world closed: **cam locks, quarter-turn locks, enclosure locks, locker/furniture locks**, and other OEM-friendly locking components used in **electrical cabinets, switchgear, lockers, vending/utility enclosures, postal equipment, and industrial furniture**. It's the kind of brand you don't notice until a whole site can't open a cabinet, and then suddenly it's the main character.

Today, **RONIS is a brand within the DOM Security group** (often referenced as **DOM RONIS**), and it's positioned as one of the major players in **industrial locks and mechanical components** for manufacturers.

What RONIS is really about is **OEM / turnkey supply**: providing manufacturers with ready-to-integrate locking solutions rather than one-off "retail" locks. DOM's own positioning for DOM RONIS is explicitly **designing, manufacturing and marketing OEM security systems for industry** and delivering **turnkey solutions**.

On the product side, the brand is heavily associated with **robust cam lock families**—e.g., models like the **RONIS 8800 / 32150 / 1710** ranges are described as cast, one-piece bodies aimed at durability and proven performance (the "this cabinet will be opened 12,000 times and nobody will lubricate it" design philosophy).