

RONIS 18600 Round Drawer Furniture Lock

Furniture Lock · Ronis · 2 variants

PRICING

From £22.29 ex VAT

£26.75 inc VAT

2 variants available

VAT 20.00%

Range: £22.29 - £26.01 ex VAT

Product Imagery

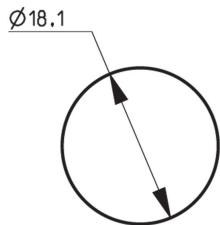
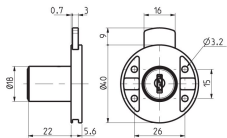

Specification Summary

Brand

Ronis

Product type

Furniture Lock

Product Description

The RONIS 18600 Round Drawer Furniture Lock is a robust and reliable locking solution designed for wooden furniture, office desks, and cabinets. Manufactured from high-quality materials, this lock is suitable for drawers with a material thickness of up to 22mm. It features a round face with a 40mm backplate and is finished in bright nickel, offering a clean and professional appearance.

Installation is straightforward thanks to the four 3.2mm screw fixing holes, ensuring a secure and stable fit. The lock operates with a 180° clockwise turn to unlock, providing a 9mm bolt throw for dependable security. For added convenience, the key can be removed in both the locked and unlocked positions.

This lock is available in multiple keying configurations, including **Keyed Alike** and **Master Keyed** options under the SM key series, which offers up to 200 different key combinations. Please select your preferred keying option from the options below.

Technical Specifications

- **Brand:** Ronis
- **Body Length:** 22mm
- **Body Diameter:** 40mm
- **Nozzle Diameter:** 18mm
- **Bolt Throw:** 9mm
- **Fixing:** Screw (4 x 3.2mm holes)
- **Key Series:** SM Series (200 differs)
- **Mechanism:** Wafer
- **Movement:** 180° clockwise
- **Key Removal:** Locked and unlocked positions
- **Finish:** Bright Nickel
- **Keys Supplied:** 2

Key Features

- **Versatile Application:** Ideal for securing wooden furniture, cupboards, and desk drawers up to 22mm thick.
- **Secure Installation:** Features a round backplate with four screw-fixing locations for a robust and stable fit.
- **Flexible Keying Options:** Available in Keyed Alike and Master Keyed configurations - please choose your preferred option below.
- **Durable Construction:** Made from high-quality materials with a bright nickel finish for long-lasting performance.
- **Convenient Operation:** Features a 9mm bolt throw with a key that can be removed in both locked and unlocked positions.

Variant Specifications And Pricing

Image	Part Number	Ex VAT	Inc VAT	Attributes / Specs
	L26844	£26.01	£31.21	<p>Barcode: 5055120781440</p> <p>Body Diameter: 40mm</p> <p>Body Length: 22mm</p> <p>Bolt Throw: 9mm</p> <p>Brand: Ronis</p> <p>Differs: 200</p> <p>Finish: Bright Nickel</p> <p>Fixing: Screw</p> <p>Head Diameter: 18mm</p> <p>Key Series: SM</p> <p>Keyed: Master Keyed</p> <p>Keying - MK: Stocked</p> <p>Keys Supplied: 2</p> <p>Manufacturer Reference: 18600-DR1-L3-SM</p> <p>Mechanism: Wafer</p> <p>Movement: 180° Clockwise</p> <p>Notes: Cam Fixing ID - CX, Direction ID - DR1, Hole Profile - 30800 & Lock Fixing ID - L3</p> <p>Nozzle Diameter: 18mm</p> <p>Pack Quantity: 1</p> <p>Weight: 60g</p>

Image

Part Number

Ex VAT

Inc VAT

Attributes / Specs



L27421

£22.29

£26.75

Barcode: 5055120785066

Body Diameter: 40mm

Body Length: 22mm

Bolt Throw: 9mm

Brand: Ronis

Differs: 200

Finish: Bright Nickel

Fixing: Screw

Head Diameter: 18mm

Key Series: SM

Keyed: Keyed Alike

Keying - MK: Stocked

Keys Supplied: 2

Manufacturer Reference: 18600-DR1-L3-SM

Mechanism: Wafer

Movement: 180° Clockwise

Notes: Cam Fixing ID - CX, Direction ID - DR1, Hole Profile - 30800 & Lock Fixing ID - L3

Nozzle Diameter: 18mm

Pack Quantity: 1

Weight: 60g

Brand Profile

Ronis



RONIS is an industrial locking brand best known for the unglamorous-but-essential stuff that keeps the modern world closed: **cam locks, quarter-turn locks, enclosure locks, locker/furniture locks**, and other OEM-friendly locking components used in **electrical cabinets, switchgear, lockers, vending/utility enclosures, postal equipment, and industrial furniture**. It's the kind of brand you don't notice until a whole site can't open a cabinet, and then suddenly it's the main character.

Today, **RONIS is a brand within the DOM Security group** (often referenced as **DOM RONIS**), and it's positioned as one of the major players in **industrial locks and mechanical components** for manufacturers.

What RONIS is really about is **OEM / turnkey supply**: providing manufacturers with ready-to-integrate locking solutions rather than one-off "retail" locks. DOM's own positioning for DOM RONIS is explicitly **designing, manufacturing and marketing OEM security systems for industry** and delivering **turnkey solutions**.

On the product side, the brand is heavily associated with **robust cam lock families**—e.g., models like the **RONIS 8800 / 32150 / 1710** ranges are described as cast, one-piece bodies aimed at durability and proven performance (the "this cabinet will be opened 12,000 times and nobody will lubricate it" design philosophy).