

GEZE TS1000C Size 2-3 Overhead Door Closer

Overhead · Geze · 1 variant

PRICING

From £54.21 ex VAT

£65.05 inc VAT

1 variant available
VAT 20.00%

Product Imagery

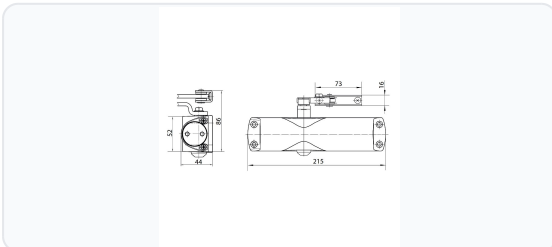

Specification Summary

Brand	Geze
Product type	Overhead

Product Description

The GEZE TS1000C is a versatile overhead link arm door closer designed for single-leaf internal doors. Ideal for both residential and commercial settings, it is fully reversible and can be installed on left- or right-handed doors without any conversion. It is also suitable for use on fire and smoke protection doors.

This door closer offers a variable closing force of EN size 2 or 3, which is easily adjusted by turning the link arm's bearing block. Setting it to EN 2 is ideal for door widths up to 850mm, while EN 3 supports doors up to 950mm wide with a maximum door weight of 60kg.

The TS1000C features fully adjustable closing speed and hydraulic latching action, allowing you to fine-tune the door's closing cycle to suit your specific environment. This ensures a smooth, controlled close and reliable latching every time.

Technical Specifications

- **Brand:** GEZE
- **Model:** TS1000C
- **Power Size:** EN 2 to 3 (adjustable via bearing block)
- **Max Door Width:** 950mm
- **Max Door Weight:** 60kg
- **Body Length:** 215mm
- **Body Height:** 52mm
- **Body Depth:** 44mm
- **Finish:** Silver
- **Handing:** Reversible (non-handed)
- **Adjustable Closing Speed:** Yes
- **Adjustable Latch Action:** Yes
- **Backcheck:** No
- **Hold Open:** No

Key Features

- **Variable Closing Force:** Easily switch between EN size 2 and 3 by simply turning the link arm bearing block.
- **Fully Adjustable:** Features independent adjustments for both closing speed and hydraulic latching action.
- **Reversible Design:** Suitable for both left- and right-handed single-action internal doors without conversion.
- **Fire Door Suitable:** Approved for use on fire and smoke protection doors.
- **Compact Profile:** Sleek silver body with a depth of just 44mm, offering a neat and unobtrusive installation.

Variant Specifications And Pricing

Image	Part Number	Ex VAT	Inc VAT	Attributes / Specs
	L27483	£54.21	£65.05	<p> Adjustable Closing Speed: Yes Adjustable Latch Action: Yes Backcheck: No Barcode: 5055120786261 Body Depth: 44mm Body Height: 52mm Body Length: 215mm Brand: Geze Finish: Silver Handed: Reversible Hold Open: No Manufacturer Reference: TS1000C Max Door Width: 950mm Pack Quantity: 1 Strength Size: 2 To 3 Weight: 1.317Kg Width: 21.5cm </p>

Brand Profile

Geze



GEZE is a German, **family-owned** global manufacturer of **door, window, and safety technology**, best known in the trade for **door closers, automatic door systems** (sliding/swing/revolving), **window drives**, and **smoke & heat extraction (SHEV)** solutions used in modern building safety and automation.

Founded in **1863**, GEZE remains independently owned and headquartered in **Leonberg**, near Stuttgart - one of the reasons it's often described as a "proper engineering company" rather than a brand label slapped on a catalogue.

In practical terms, GEZE lives in the space where **comfort meets compliance**:

- **Door closing**: from standard overhead closers to integrated systems for higher-spec doors and fire/smoke applications.
- **Automatic entrances**: operators for swing and sliding doors used in public buildings, retail, airports, offices—accessibility and flow without sacrificing safety.
- **Safety + building automation**: electrically operated window systems for **natural ventilation** and for **smoke and heat extraction** in a fire, plus increasing emphasis on digital networking of doors/windows in "smart building" setups.

Scale-wise, GEZE states it has **3,000+ employees worldwide, 37 subsidiaries**, and reported **€507m+ turnover (FY 2022/23)** - big enough to be everywhere, still small enough to feel focused.