

EXIDOR 302 Knob Operated Outside Access Device With Cylinder

Outside Access Device - Exidor - 1 variant

PRICING

From £260.18 ex VAT

£312.22 inc VAT

1 variant available
VAT 20.00%

Product Imagery

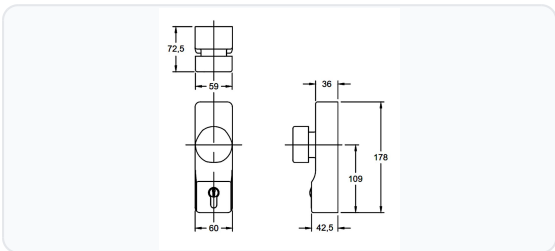

Specification Summary

Brand	Exidor
Product type	Outside Access Device

Product Description

The Exidor 302 Knob Operated Outside Access Device (OAD) provides a secure and reliable solution for external access on doors fitted with emergency exit hardware. Supplied complete with a 40mm Euro profile cylinder and three keys, this unit is fully compatible with Exidor 200 and 300 series panic bolts and latches.

Designed for versatility, the Exidor 302 is non-handed and suitable for both timber and steel doors up to 45mm thick. It features a smart silver enamelled finish and is fire-rated, CE marked, and Certifire approved.

When locked, the internal mechanism disengages, allowing the round knob to rotate freely. This clever design prevents forced entry by resisting pulling, prying, and twisting attacks. Unlocking the cylinder engages the knob, allowing users to retract the internal panic hardware and gain entry. The device is surface-mounted from the outside using concealed bolt-through machine screws, ensuring a clean, secure installation.

Technical Specifications

- **Brand:** Exidor
- **Manufacturer Reference:** 302SE
- **Finish:** Silver Enamelled
- **Cylinder Type:** 40mm Euro profile cylinder (supplied with 3 keys)
- **Door Thickness:** Suitable for timber and steel doors up to 45mm thick
- **Handing:** Reversible (non-handed)
- **Compatibility:** Exidor 200 & 300 series bolts and latches
- **Standards:** CE Marked, Certifire approved
- **Width:** 60mm
- **Depth:** 70mm
- **Body Depth:** 43mm
- **Knob Projection:** 27mm
- **Weight:** 900g
- **Pack Quantity:** 1

Key Features

- **Free-Spinning Knob:** When locked, the mechanism disengages to allow the knob to rotate freely, resisting pulling and prying attacks.
- **Fire Rated:** Certifire approved for use on both timber and steel fire doors.
- **Supplied with Cylinder:** Includes a 40mm Euro profile cylinder and three keys as standard.
- **Concealed Fixings:** Surface-mounted on the outside of the door using secure, concealed machine screws.
- **Fully Reversible:** Non-handed design ensures easy installation on both left and right-handed doors.
- **Robust Construction:** Durable silver enamelled finish suitable for commercial and public buildings.

Variant Specifications And Pricing

Image	Part Number	Ex VAT	Inc VAT	Attributes / Specs
	L11569	£260.18	£312.22	Barcode: 5013904851086 Body Depth: 43mm Brand: Exidor Depth: 70mm Finish: Silver Enamelled Handed: Reversible Knob Projection: 27mm Manufacturer Reference: 302SE Pack Quantity: 1 Packaging: Boxed Standards: CE Marked, Certifire Weight: 900g Width: 60mm

Brand Profile

Exidor

 The logo for Exidor features the word "EXIDOR" in a bold, black, sans-serif font. A thick black horizontal line is positioned above the letters "I" and "D", extending from the top of the "I" to the top of the "R".

Exidor is a UK panic-and-emergency-exit hardware brand best known for **push bars, push pads, and multi-point exit devices** used on fire exits and escape routes in commercial buildings. It's one of those "you don't notice it until you *really* need it" brands—built around reliable, standards-compliant egress hardware.

Exidor says it has been a leading manufacturer in this category for **around 90 years**, and trade/brand info places its establishment at **1931**.

Standards & compliance are central to the brand's positioning: Exidor panic and emergency exit devices are marketed as **CE marked** and **tested to EN 1125 (panic exit devices)** and **EN 179 (emergency exit devices)**—the core European standards that specifiers and installers care about for public buildings and controlled escape routes.

Ownership / group: Exidor was acquired by **ASSA ABLOY Opening Solutions UK & Ireland in 2018** (widely reported in trade press), and Companies House filings list **Assa Abloy Limited** as the controlling party.

Where it sits today: Exidor is now presented as a **range within the UNION family** (ASSA ABLOY's UK door hardware portfolio), and the brand is used across "real world" commercial projects where you might need bespoke finishes, different keep/bolt options, alarms, or microswitch variants for monitoring.