

DORMAKABA BTS75V Floor Spring Door Closer

Floor · dormakaba · 1 variant

PRICING

From £248.83 ex VAT

£298.60 inc VAT

1 variant available
VAT 20.00%

Product Imagery

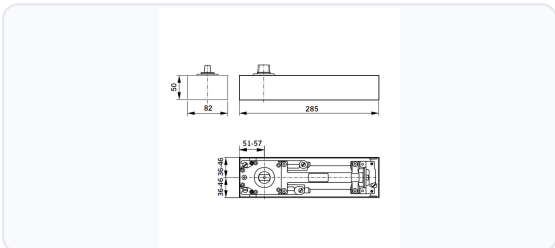

Specification Summary

Brand dormakaba

Product type Floor

Product Description

The dormakaba BTS75V (formerly Dorma) is a highly adaptable, universal floor spring door closer designed for both single and double-action doors. Suitable for door widths up to 1100mm and leaf weights up to 120kg, this concealed floor spring is a versatile choice for a wide range of applications.

This non-hold open model features an adjustable spring strength (size EN 1 to 4), allowing the closing force to be individually regulated to suit your specific door requirements. It also incorporates a mechanical backcheck to protect the door and surrounding walls from damage caused by forceful opening.

Designed for concealed installation, the BTS75V provides a clean, unobtrusive aesthetic while remaining virtually maintenance-free. It is fire-tested for up to 1 hour on timber doors and up to 4 hours on metal doors, making it a reliable and safe choice for commercial and residential environments.

Technical Specifications

- **Brand:** dormakaba
- **Manufacturer Reference:** BTS75V
- **Strength Size:** EN 1 to 4 (adjustable)
- **Max Door Width:** 1100mm
- **Max Door Weight:** 120kg
- **Fire Tested:** 1 Hour Timber & 4 Hours Metal
- **Handing:** Reversible
- **Hold Open:** No
- **Adjustable Latch Action:** Yes
- **Backcheck:** Yes
- **Dimensions:** 285mm (L) x 82mm (W) x 50mm (H/D)
- **Weight:** 3.26kg

Key Features

- **Universal Application:** Suitable for single or double-action doors, depending on the accessories used.
- **Adjustable Closing Force:** Spring strength can be easily regulated to ensure smooth and reliable closing.
- **Integrated Backcheck:** Helps prevent damage to the door and wall by cushioning violent opening.
- **Concealed Design:** Installed flush with the floor for a sleek, minimalist appearance.
- **Low Maintenance:** Virtually maintenance-free, requiring only routine dusting and cleaning.
- **Fire Rated:** Certified for use on 1-hour timber and 4-hour metal fire doors.

Variant Specifications And Pricing

Image	Part Number	Ex VAT	Inc VAT	Attributes / Specs
	L11540	£248.83	£298.60	<p>Adjustable Latch Action: Yes</p> <p>Backcheck: Yes</p> <p>Barcode: 4021226010839</p> <p>Brand: dormakaba</p> <p>Depth: 50mm</p> <p>Fire Tested: 1 Hour Timber & 4 Hours Metal</p> <p>Handed: Reversible</p> <p>Height: 50mm</p> <p>Hold Open: No</p> <p>Length: 28.5cm</p> <p>Manufacturer Reference: BTS75V</p> <p>Max Door Weight: 120Kg</p> <p>Max Door Width: 1100mm</p> <p>Pack Quantity: 1</p> <p>Packaging: Boxed</p> <p>Strength Size: 1 To 4</p> <p>Weight: 3.26Kg</p> <p>Width: 82mm</p>

Brand Profile

dormakaba



dormakaba is a Swiss-headquartered global access-solutions company that builds the stuff that makes buildings actually *work*: **door hardware, door closers, automatic entrances, electronic access control, and keying/locking systems** across commercial, residential, and institutional sites. The group is based in **Rümlang (Zurich), Switzerland** and sells into **50+ countries** with a large installed base in doors, hotels, airports, offices, and public buildings.

The modern company was created through the **merger of Germany's dorma and Switzerland's Kaba**, finalized in **September 2015** (initially branded "dorma+kaba," later standardized as **dormakaba**). That merger fused two long-running lineages: **DORMA (founded 1908 in Ennepetal, Germany)** with deep door-technology roots, and **Kaba** with a long history in locking/identification (origins going back to the 19th century in Zurich).

What dormakaba is known for in the trade/spec world is the "whole doorway" approach:

- **Door hardware + control** (closers, floor springs, related hardware)
- **Entrance systems** (automatic doors, turnstiles/personnel gates depending on market)
- **Access control & identity** (credentials, electronic locking, and management layers)

Scale-wise, dormakaba reported **net sales of CHF 2.87bn** for **FY 2024/25** and **~15k employees** (15,346 cited), reflecting a genuinely large global footprint.