

BRITON 389.N Push Pad Emergency Exit Mortice Nightlatch

Panic Latch · Briton · 1 variant

PRICING

From £303.47 ex VAT

£364.16 inc VAT

1 variant available
VAT 20.00%

Product Imagery

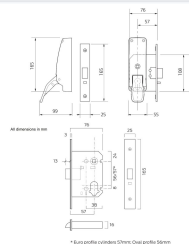
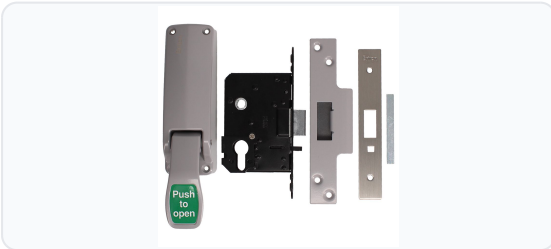

Specification Summary

Brand	Briton
Product type	Panic Latch

Product Description

The Briton 389.N Push Pad Emergency Exit Mortice Nightlatch is a high-quality, reliable escape solution designed for doors on designated escape routes. Fully certified to BS EN 179, this emergency exit device is ideal for use in commercial and public buildings where personnel are familiar with the exit routes. It is suitable for single doors and the active leaf of non-rebated double doors up to 1300mm wide.

This surface-mounted push pad operates a robust mortice nightlatch. It features an integrated anti-thrust mechanism to prevent unauthorised forced retraction of the latch from the outside, ensuring high security when the premises are closed. The supplied dual-profile mortice nightlatch is highly versatile, accepting both Euro and oval profile cylinders (cylinders are sold separately).

Designed for straightforward installation, the unit is fully site-reversible to suit both left and right-handed doors. It comes in a durable silver enamelled finish and includes the standard green and white "Push To Open" sign.

Technical Specifications

- **Brand:** Briton
- **Manufacturer Reference:** 389.N.SE
- **Standards:** CE & UKCA Marked, BS EN 179, Certifire Approved (CF5506)
- **Fire Testing:** Tested to EN 1634-1 for timber and steel fire doors
- **Maximum Door Width:** 1300mm
- **Cylinder Compatibility:** Accepts Euro and oval profile cylinders (cylinder not included)
- **Handing:** Reversible (suitable for left or right-handed doors)
- **Finish:** Silver Enamelled
- **Weight:** 1.43kg

Key Features

- **Certified Safety:** Fully certified to BS EN 179 for emergency exit applications.
- **Enhanced Security:** Integrated anti-thrust device prevents unauthorised forced retraction of the latch.
- **Versatile Locking:** Supplied with a dual-profile mortice nightlatch compatible with Euro and oval cylinders.
- **Flexible Installation:** Site-reversible design makes it easy to hand on-site for left or right-opening doors.
- **Complete Package:** Includes a green and white "Push To Open" legend sign.
- **Application:** Ideal for single doors or the first opening leaf of a double door.

Variant Specifications And Pricing

Image	Part Number	Ex VAT	Inc VAT	Attributes / Specs
	L25916	£303.47	£364.16	<p>Barcode: 5050640030023 Brand: Briton Finish: Silver Enamelled Handed: Reversible Legend: Push To Open Manufacturer Reference: 389.N.SE Max Door Width: 1300mm Pack Quantity: 1 Packaging: Boxed Standards: CE Marked, BS EN 179 Weight: 1.43Kg</p>

Brand Profile

Briton



Briton is a long-established UK door hardware brand best known for **door controls** and **exit hardware** used in commercial buildings where reliability and fire-safety compliance actually matter. Briton markets itself as having **over 100 years** of history in the sector, with a reputation built on “highly engineered” products designed to survive constant, unglamorous punishment in busy environments.

Today, **Briton is part of Allegion** (the global security group behind multiple access and door hardware brands). In the Allegion portfolio, Briton sits as a specialist name for door control and emergency exit solutions.

What Briton is typically associated with in the trade/spec world:

- **Overhead door closers** (including their long-running “classic” closer heritage)
- **Panic and emergency exit devices** such as push bars and push pads, designed and tested to standards like **EN 1125** (panic) and **EN 179** (emergency exit) depending on application
- A broader ecosystem that now extends into related **locks, cylinders, door furniture and accessories** under the Briton hallmark

Fun bit of heritage trivia that specs people love: [sources discussing Briton’s classic door closer lineage note early Briton closers being manufactured by William Newman & Sons Ltd in Birmingham in the 1930s, and that the traditional style still shows up in places like historic properties.](#)