

ASEC Spring Bolt Cylinder Till Lock

Till & Drawer Lock · Asec · 2 variants

PRICING

From £36.66 ex VAT

£43.99 inc VAT

2 variants available

VAT 20.00%

Range: £36.66 - £51.71 ex VAT

Product Imagery

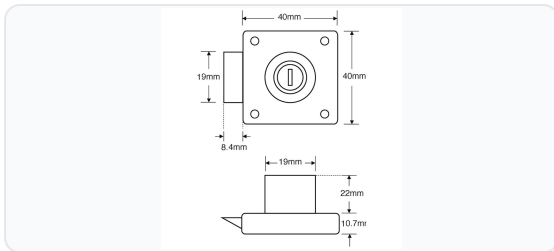

Specification Summary

Brand	Asec
Product type	Till & Drawer Lock

Product Description

The Asec Spring Bolt Cylinder Till Lock is a secure latchbolt furniture lock designed primarily for wooden drawers and cabinets. Mounted on the inside of the drawer, it features a spring latch mechanism that automatically locks the drawer when it is shut. To open, simply use the key to retract the latch.

This lock features a 16mm diameter nozzle and a square backplate, making it a robust and reliable choice for securing cash drawers, till units, and office furniture. For enhanced security, it is equipped with a 10-pin radial (tubular) key tumbler mechanism.

Depending on your security requirements, this lock is available in multiple options, including Keyed Alike (KA Key Number 10692) or Keyed to Differ (KD). The weight of the lock varies between 110g and 286g depending on the chosen variant. Please select your preferred keying option and manufacturer reference (AS9951 or AS10118) from the options below.

Technical Specifications

- **Nozzle Diameter:** 16mm
- **Backplate:** Square
- **Key Mechanism:** 10-pin radial key tumbler
- **Finish:** Satin Chrome
- **Keys Supplied:** 1
- **Keying Options:** Keyed Alike or Keyed to Differ (please select from the options below)
- **Manufacturer Reference:** AS9951 or AS10118 (please select from the options below)
- **Weight:** 110g to 286g (depending on the variant selected)

Key Features

- **Automatic Locking:** Spring latch automatically locks the drawer or cabinet when shut
- **Enhanced Security:** Features a highly secure 10-pin radial key tumbler mechanism
- **Versatile Application:** Ideal for wooden furniture, till drawers, and office cabinets
- **Easy Operation:** Key retracts the latchbolt to allow quick access
- **Multiple Configurations:** Available in Keyed Alike or Keyed to Differ options to suit your security setup

Variant Specifications And Pricing

Image	Part Number	Ex VAT	Inc VAT	Attributes / Specs
	AS10118	£51.71	£62.05	Barcode: 5055120735597 Brand: Asec Finish: Satin Chrome Keyed: Keyed Alike Keying - KA: Stocked Keys Supplied: 1 Manufacturer Reference: AS10118 Notes: KA Key Number: 10692 Pack Quantity: 1 Weight: 286g
No image	AS9951	£36.66	£43.99	Finish: Satin Chrome Keyed: Keyed To Differ Keys Supplied: 1 Manufacturer Reference: AS9951 Pack Quantity: 1 Weight: 110g

Brand Profile

Asec



ASEC is a **trade-focused security hardware brand** built around the “everyday kit” locksmiths and installers reach for, with a big emphasis on **breadth, availability, and value** rather than boutique-only spec pieces. The brand was **established in 2003** and was created specifically to **support independent retailers and security professionals** with products that *“would never become available through the large multiple retailers.”*

Where ASEC gets especially interesting (and why it tends to become a “default stock brand”) is the **scale of the range**:

- ASEC positions itself as having a portfolio of **2,000+ individual products**, described as one of the **largest ranges under a single security brand name** in the industry.
- Coverage is intentionally broad across the core trade categories: **Access Control, Architectural Hardware, Key Cutting, Locking Products, UPVC, Tools & Accessories.**

ASEC is **exclusive to Aldridge Security** (whom we distribute) in the UK trade ecosystem (Aldridge explicitly calls itself the **exclusive distributor of ASEC Security Products worldwide**). That exclusivity is a big part of the brand's identity: it keeps the range aimed at the trade channel rather than getting diluted into mass retail.