

ASEC Open Shackle Recodable Combination Padlock

Combination · Asec · 2 variants

PRICING

From £19.22 ex VAT

£23.06 inc VAT

2 variants available

VAT 20.00%

Range: £19.22 - £19.68 ex VAT

Product Imagery

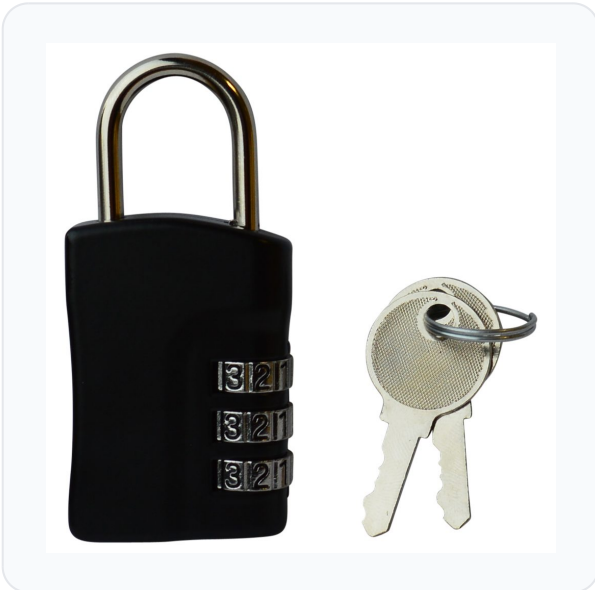

Specification Summary

Brand Asec

Product type Combination

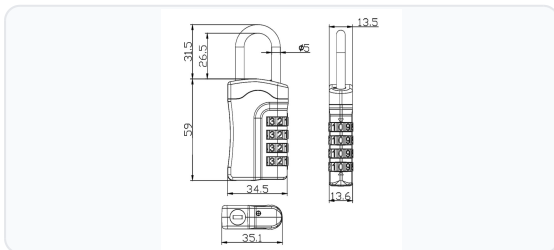
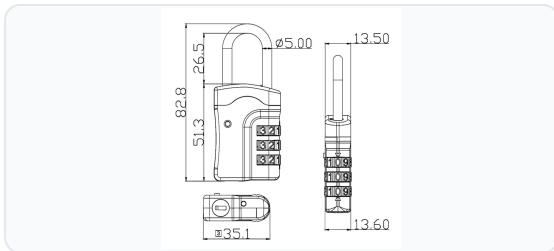

Product Description

The Asec Open Shackle Recodable Combination Padlock is a highly versatile security solution designed for environments where multiple users require access, such as schools, colleges, and sports facilities. Featuring a robust zinc alloy body and a hardened iron steel open shackle, this padlock offers a strong physical deterrent against tampering.

A key benefit of this padlock is its key override function. Each padlock is supplied with 2 keys (keyed alike in sets of 50), allowing administrators or facility managers to unlock the padlock without needing the combination code. This is particularly useful for locker management when codes are forgotten.

This padlock is available in both 3-wheel and 4-wheel combination mechanisms, providing either 1,000 or 10,000 potential resettable combinations. Depending on the model selected, the padlock features a body height of 52mm or 60mm, a shackle diameter of 5mm or 5.2mm, and a weight of 102g or 114g. Please choose your preferred configuration from the options below.

Technical Specifications

- **Brand:** Asec
- **Manufacturer Reference:** AS11476 or AS11477 (please choose from the options below)
- **Body Width:** 35mm
- **Body Depth:** 14mm
- **Body Finish:** Black
- **Body Height:** 52mm or 60mm (please choose from the options below)
- **Shackle Diameter:** 5mm or 5.2mm (please choose from the options below)
- **Shackle Finish:** Steel
- **Horizontal Clearance:** 16mm
- **Vertical Clearance:** 26.5mm
- **Mechanism:** 3 Wheel or 4 Wheel Combination (please choose from the options below)
- **Keys Supplied:** 2 keys (keyed alike in sets of 50)
- **Weight:** 102g or 114g (please choose from the options below)

Key Features

- **Robust Construction:** Zinc alloy body with a hardened iron steel open shackle.
- **Resettable Combination:** Easily change the code, with up to 1,000 (3-wheel) or 10,000 (4-wheel) potential combinations.
- **Key Override Function:** Supplied with 2 keys (keyed alike in sets of 50) for quick unlocking without a code.
- **Ideal for Shared Facilities:** Perfect for use in schools, colleges, and sports locker rooms.
- **Multiple Options Available:** Choose from different heights, weights, and mechanisms to suit your requirements.

Variant Specifications And Pricing

Image	Part Number	Ex VAT	Inc VAT	Attributes / Specs
	AS11476	£19.22	£23.06	Barcode: 5055120785042 Body Depth: 14mm Body Finish: Black Body Height: 52mm Body Width: 35mm Brand: Asec Horizontal Clearance: 16mm Keys Supplied: 2 Manufacturer Reference: AS11476 Mechanism: Combination (3 Wheel) Pack Quantity: 1 Shackle Diameter: 5.2mm Shackle Finish: Steel Vertical Clearance: 26.5mm Weight: 102g
No image	AS11477	£19.68	£23.62	Body Height: 60mm Body Width: 35mm Horizontal Clearance: 16mm Keys Supplied: 2 Manufacturer Reference: AS11477 Mechanism: Combination (4 Wheel) Pack Quantity: 1 Shackle Diameter: 5mm Shackle Finish: Steel Vertical Clearance: 26.5mm Weight: 114g

Brand Profile

Asec



ASEC is a **trade-focused security hardware brand** built around the “everyday kit” locksmiths and installers reach for, with a big emphasis on **breadth, availability, and value** rather than boutique-only spec pieces. The brand was **established in 2003** and was created specifically to **support independent retailers and security professionals** with products that *“would never become available through the large multiple retailers.”*

Where ASEC gets especially interesting (and why it tends to become a “default stock brand”) is the **scale of the range**:

- ASEC positions itself as having a portfolio of **2,000+ individual products**, described as one of the **largest ranges under a single security brand name** in the industry.
- Coverage is intentionally broad across the core trade categories: **Access Control, Architectural Hardware, Key Cutting, Locking Products, UPVC, Tools & Accessories.**

ASEC is **exclusive to Aldridge Security** (whom we distribute) in the UK trade ecosystem (Aldridge explicitly calls itself the **exclusive distributor of ASEC Security Products worldwide**). That exclusivity is a big part of the brand's identity: it keeps the range aimed at the trade channel rather than getting diluted into mass retail.